

San Miguel Residence Hall

Emergency Information Legend

- Evacuation Site
- Fire Alarm Pull-Box
- Disaster Kit Location
- Fire Hose
- Gas Shut-Off Location
(Do not shut off unless you smell gas)
- Fire Extinguisher
- Water Shut-Off Location
- Campus Emergency Phone
- First Aid Kit
- Pay Phone
- Safety Corner
- Courtesy Phone
- Emergency Radio
- Disabled Access
- Blanket Location
- Trash Chute
- Elevator

Typical Floor Plan

San Miguel Hall has two wings on eight floors. Room Numbers – the first of the four digits indicates the floor number, the last three digits do not necessarily correspond on all floors. Each floor has the following number sequence:

East Tower

Humboldt Hall

1st Floor (1211–1242) & 2nd Floor (2210–2241)

Mendocino Hall

3rd Floor (3210–3241) & 4th Floor (4211–4241)

Plumas Hall

5th Floor (5210–5241) & 6th Floor (6210–6241)

Stanislaus Hall

7th Floor (7210–7241) & 8th Floor (8210–8241)

2nd Floor East Tower

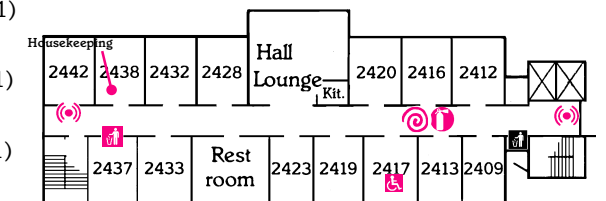

2nd Floor West Tower



West Tower

Calaveras Hall

1st Floor (1412–1442) & 2nd Floor (2409–2442)

El Dorado Hall

3rd Floor (3409–3442) & 4th Floor (4412–4442)

Mariposa Hall

5th Floor (5409–5442) & 6th Floor (6409–6442)

Sierra Hall

7th Floor (7409–7442) & 8th Floor (8409–8442)



Housing & Residential Services
University of California, Santa Barbara

Design: Flannery Designs&Graphics