

San Miguel Residence Hall

The San Miguel Residence Hall is an eight-story building located on the east side of the main campus near the lagoon and the University Center. The majority of the rooms are double occupancy, and most rooms have stunning views of the ocean, lagoon, or campus.

Meeting Spaces	Square Feet	Capacity	Meeting Spaces	Square Feet	Capacity
Formal Lounge	822	45	Floor Lounge 5200	570	20
Classroom	481	25	Floor Lounge 5400	522	20
Recreation Room	1427	50	Floor Lounge 6200	570	20
Floor Lounge 1200	570	20	Floor Lounge 6400	522	20
Floor Lounge 1400	522	20	Floor Lounge 7200	570	20
Floor Lounge 2200	570	20	Floor Lounge 7400	522	20
Floor Lounge 2400	522	20	Floor Lounge 8200	570	20
Floor Lounge 3200	570	20	Floor Lounge 8400	522	20
Floor Lounge 3400	522	20	Volleyball Court		
Floor Lounge 4200	570	20			
Floor Lounge 4400	522	20			

Amenities:

- Rooms are furnished with one or two single beds, desks, desk chairs, small chest of drawers and a closet. (Rooms do not have telephones, televisions, radios or clocks.) Guests may wish to bring a reading lamp.
- There are no phones in individual rooms.
- Wireless Internet access
- Laundry facilities
- Single-gender community bathrooms (guests may wish to bring a robe and shower shoes.)
- Room layout graphic shown is approximate in scale (actual furniture configurations may differ; beds are not "lofted" for Summer Conferences).



Walking Times

Beach	5 minutes
University Center	3 minutes
De La Guerra Dining Commons	2 minutes
Ortega Dining Commons	1 minute
Campus Point Beach	12 minutes
Bus Circle	10 minutes





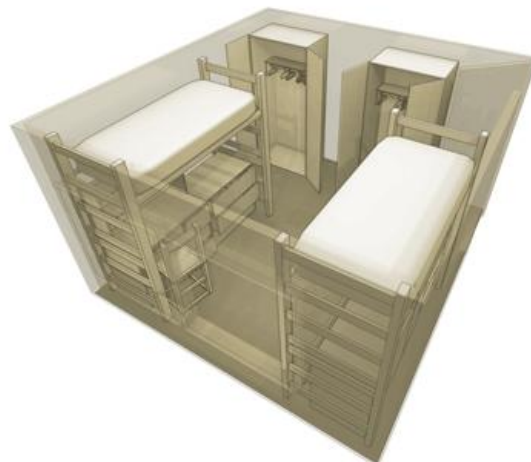









Front Desk Phone

(805) 893-2275



San Miguel Residence Hall

Emergency Information Legend

-  Evacuation Site
-  Disaster Kit Location
-  Gas Shut-Off Location
(Do not shut off unless you smell gas)
-  Water Shut-Off Location
-  First Aid Kit
-  Safety Corner
-  Emergency Radio
-  Blanket Location
-  Fire Alarm Pull-Box
-  Fire Hose
-  Fire Extinguisher
-  Campus Emergency Phone
-  Pay Phone
-  Courtesy Phone
-  Disabled Access
-  Trash Chute
-  Elevator

Typical Floor Plan

San Miguel Hall has two wings on eight floors. Room Numbers – the first of the four digits indicates the floor number; the last three digits do not necessarily correspond on all floors. Each floor has the following number sequence:

East Tower

- Humboldt Hall**
1st Floor (1211-1242) & 2nd Floor (2210-2241)
- Mendocino Hall**
3rd Floor (3210-3241) & 4th Floor (4211-4241)
- Pumas Hall**
5th Floor (5210-5241) & 6th Floor (6210-6241)
- Stanislaus Hall**
7th Floor (7210-7241) & 8th Floor (8210-8241)

2nd Floor East Tower

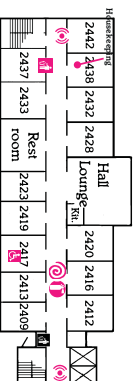

2nd Floor West Tower

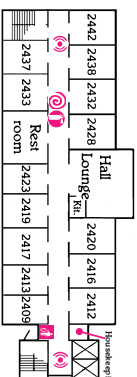

West Tower

- Calaveras Hall**
1st Floor (1412-1442) & 2nd Floor (2409-2442)
- El Dorado Hall**
3rd Floor (3409-3442) & 4th Floor (4412-4442)
- Mariposa Hall**
5th Floor (5409-5442) & 6th Floor (6409-6442)
- Sierra Hall**
7th Floor (7409-7442) & 8th Floor (8409-8442)

